

## medeco®

HIGH SECURITY LOCKS



## Cam Locks

All Medeco cam locks are protected by hardened steel anti-drill pins at critical points. All incorporate Medeco's patented, double locking principle which renders the lock virtually pickproof. Medeco cam locks are recognized by experts throughout the world as the standard for high security in a 3/4" diameter lock. No other lock can rival Medeco cam locks against surreptitious entry, resistance to physical attack, and maintenance of key integrity.

LSI Part No.	"A"	No. of Pins	Material
ME-6030	11/16"	5	Brass
ME-6053	5/8"	4	Brass
ME-6045	7/8"	5	Brass
ME-6058	3/4"	5	Brass
ME-6049	1 1/8"	5	Brass
ME-6054	1 1/2"	5	Brass

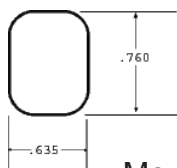
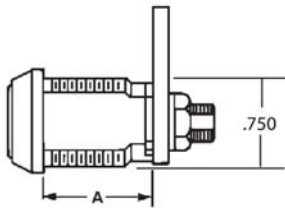

Mounting Hole

### Rotation and Keypull

- 1 = 90 Clockwise 1 Keypull
- 2 = 90 Clockwise 2 Keypulls
- 3 = 90 Counterclockwise 1 Keypull
- 4 = 90 Counterclockwise 2 Keypulls
- 5 = 180 Clockwise 1 Keypull
- 6 = 180 Clockwise 2 Keypulls
- 7 = 180 Counterclockwise 1 Keypull
- 8 = 180 Counterclockwise 2 Keypulls

When Ordering please specify the "A" dimension (length) and the rotation and keypull.